

**Kingston Road  
Raynes Park, SW20 8JP**

**£525,000 Leasehold**

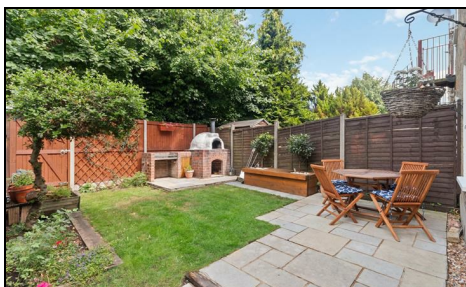

**This attractive 725 sqft TWO DOUBLE BEDROOM, ground floor Victorian Maisonette has sole use of the larger than average rear garden. Beautifully presented throughout with a lovely separate reception room with ornate fire place, exposed wood flooring and plantation shutters, a spacious bedroom with built in storage, second bedroom overlooking the garden, modern bathroom with window, a superb kitchen/dining room, a separate utility room and private garden with pizza oven and BBQ firepit. There is also bike storage to the front. Perfectly located within the Wimbledon Chase Primary School Admissions Priority Area and for access to Raynes Park and Wimbledon Chase Stations and Shops.**

**KINGSTON ROAD, SW20**

Approx. Gross Internal Floor Area  
**725 Sq. ft/67.31 Sq. m**

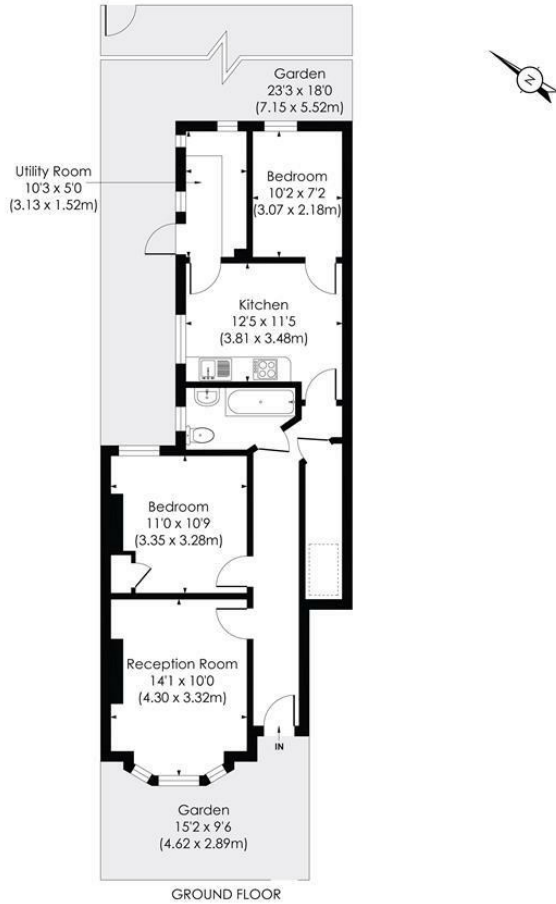

© Pixangle Property Marketing Ltd. info@pixangle.com Tel: 0208 870 2118



This floor plan has been prepared for the purpose of illustration only in accordance with the latest RICS code of measuring practice and is not to scale. All measurements and areas are approximate and whilst every effort has been made to ensure the accuracy of the plan contained here, no responsibility is taken for any error, omission or misstatement.

- 725 sqft - Two Double Bedroom
- Attractive Ground Floor Victorian Maisonette
- Larger Than Average Full Rear Garden with pizza oven and BBQ
- Kitchen/Dining Room and Separate Utility Room
- Beautiful Reception Room With Ornate Fireplace And Shutters
- Wimbledon Chase Primary School A.P.A
- Modern Family Bathroom With Window
- 104 Year Lease And Low Maintenance Charges
- Bike Storage to the front of the property
- Council Tax Band - C - EPC - C

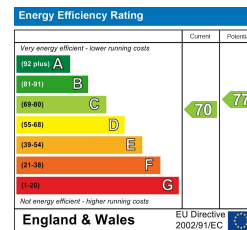

**For Free Mortgage Quote and Best Mortgage Rates, call Ellisons Mortgage Advisor on 0208 944 9595**



Although these particulars are believed to be correct, their accuracy is not guaranteed and they do not form part of any contract.

**Celebrating 30 years of successful Sales and Lettings in Merton**

